



GILDEMEISTER

TORRETTA SAUTER VDI30 DIN 5480

CTX210/CTX310
CTX 320 LINEAR
CTX410/CTV160
CTX ALPHA 500

SA.000.3080

AXIAL



ER-25
RATIO 1:1
6.000 RPM MAX

SA.010.3080

RADIAL

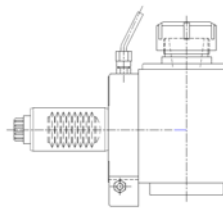

ER-25
RATIO 1:1
6.000 RPM MAX.

SA.011.3080

**RADIAL
SET-BACK**

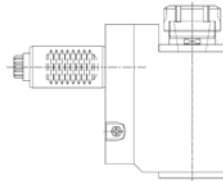

ER-25
RATIO 1:1
6.000 RPM MAX.

SA.008.3080

**RADIAL DOUBLE
OUTPUT**

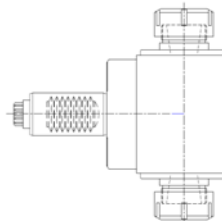

ER-20
RATIO 1:1
6.000 RPM MAX.

SA.021.3080

**RADIAL
ADJUSTABLE**

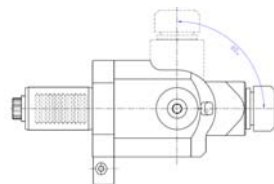

ER-16
RATIO 1:1
6.000 RPM MAX.

SA.030.3080

SAW CUTTING

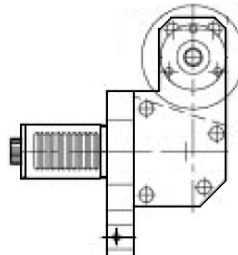

RATIO 1:1
3.000 RPM MAX.

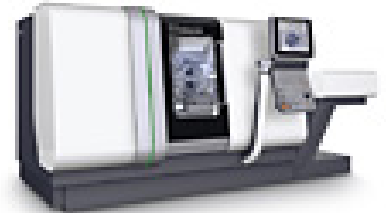

SPECIALS: NO PROBLEM



MULTI-matic srl

VIA GIOVANNI PASCOLI,4
40036 MONZUNO BO

TEL.: +39 051 6773034

FAX.: +39 051 6771049

SITO:www.multi-maticsr.com

E-MAIL: commerciale@multi-maticsr.com



GILDEMEISTER

TORRETTA SAUTER VDI40 DIN 5480

CTX410/CTX510
CTX 420 LINEAR
CTX 520 LINEAR
CTX BETA 500
CTX BETA 800
CTX BETA 1250
CTV250/CTV400

SA.000.4080

AXIAL



ER-32
RATIO 1:1
5.000 RPM MAX.

SA.010.4080

RADIAL

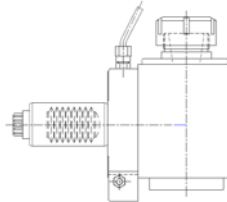

ER-32
RATIO 1:1
5.000 RPM MAX.

SA.011.4080

**RADIAL
SET-BACK**

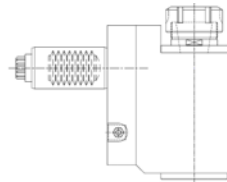

ER-32
RATIO 1:1
5.000 RPM MAX.

SA.008.4080

**RADIAL DOUBLE
OUTPUT**

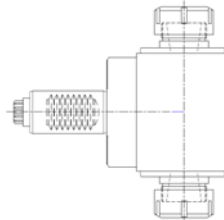

ER-25
RATIO 1:1
5.000 RPM MAX.

SA.021.4080

**RADIAL
ADJUSTABLE**

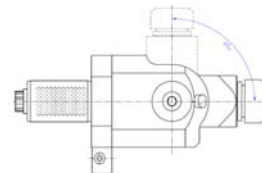

ER-25
RATIO 1:1
5.000 RPM MAX.

SA.030.4080

SAW CUTTING

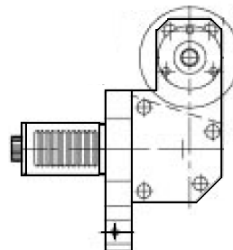

RATIO 1:1
3.000 RPM MAX.



SPECIALS: NO PROBLEM



MULTI-matic srl

VIA GIOVANNI PASCOLI,4
40036 MONZUNO BO

TEL.: +39 051 6773034

FAX.: +39 051 6771049

SITO: www.multi-maticsr.com

E-MAIL: commerciale@multi-maticsr.com



GILDEMEISTER

TORRETTA SAUTER VDI50 DIN 5480

CTX620 LINEAR
CTXGAMMA 1250
CTXGAMMA 2000

SA.000.5080

AXIAL

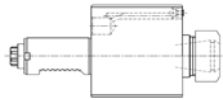

ER-40
RATIO 1:1
4.000 RPM MAX.

SA.010.5080

RADIAL

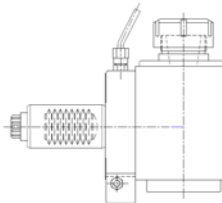

ER-40
RATIO 1:1
4.000 RPM MAX.

SA.011.5080

**RADIAL
SET-BACK**

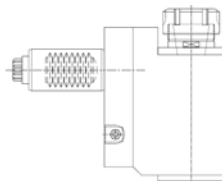

ER-40
RATIO 1:1
4.000 RPM MAX.

SA.008.5080

**RADIAL DOUBLE
OUTPUT**

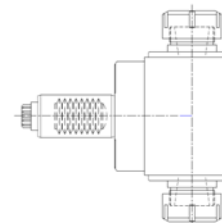

ER-32
RATIO 1:1
4.000 RPM MAX.

SA.021.5080

**RADIAL
ADJUSTABLE**

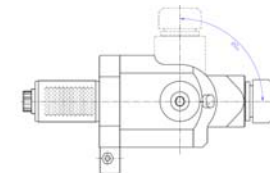

ER-32
RATIO 1:1
4.000 RPM MAX.

SA.030.5080

SAW CUTTING

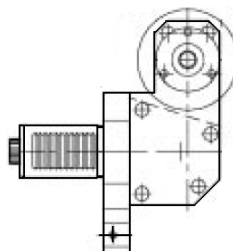

RATIO 1:1
2.500 RPM MAX.



SPECIALS: NO PROBLEM



MULTI-matic srl

VIA GIOVANNI PASCOLI,4
40036 MONZUNO BO

TEL.: +39 051 6773034

FAX.: +39 051 6771049

SITO:www.multi-maticsr.com

E-MAIL: commerciale@multi-maticsr.com



GILDEMEISTER

TORRETTA SAUTER VDI30 DIN 5480

SPRINT 42
SPRINT 50
SPRINT 65

SA.000.3080

AXIAL



ER-25
RATIO 1:1
6.000 RPM MAX.

SA.010.3080

RADIAL

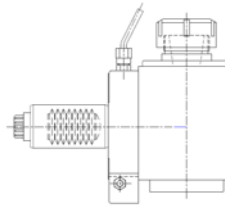

ER-25
RATIO 1:1
6.000 RPM MAX.

SA.011.3080

**RADIAL
SET-BACK**

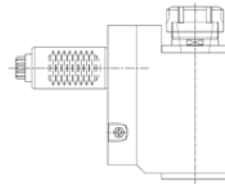

ER-25
RATIO 1:1
6.000 RPM MAX.

SA.008.3080

**RADIAL DOUBLE
OUTPUT**

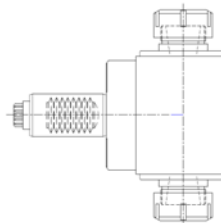

ER-20
RATIO 1:1
6.000 RPM MAX.

SA.021.3080

**RADIAL
ADJUSTABLE**

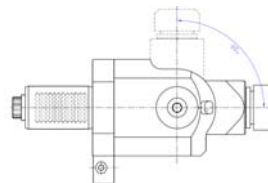

ER-16
RATIO 1:1
6.000 RPM MAX.

SA.030.3080

SAW CUTTING

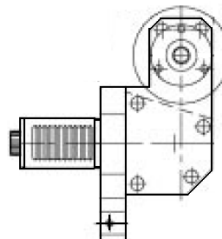

RATIO 1:1
3.000 RPM MAX.



SPECIALS: NO PROBLEM



MULTI-matic srl

VIA GIOVANNI PASCOLI,4
40036 MONZUNO BO

TEL.: +39 051 6773034

FAX.: +39 051 6771049

SITO: www.multi-maticsr.com

E-MAIL: commerciale@multi-maticsr.com